



Westfield Fasteners Product Specification:

Swivel Shackle with Eye and Fork

This product guide contains the specification for Swivel Shackles with an Eye and Fork or Jaws: standard marine parts available from Westfield Fasteners.

Product Description

Swivel shackles are designed to help prevent twisting, knotting and snagging on a line or chain. Excessive twisting in a rope or chain line can cause kinking that could reduce the line's effectiveness and potentially cause damage. Swivel shackles are available with either an eye or jaw fitting at each of its two ends, and so a small number of variations on the basic design are available. The shackle ends pivot on a central pin which the retaining nuts are welded to. As with other shackle types, the jaw or fork of a swivel style shackle opens with a threaded pin and allows it to be connected to a pre-existing system of ropes or chains.

These A4 marine grade stainless steel swivel shackles are strong and durable.

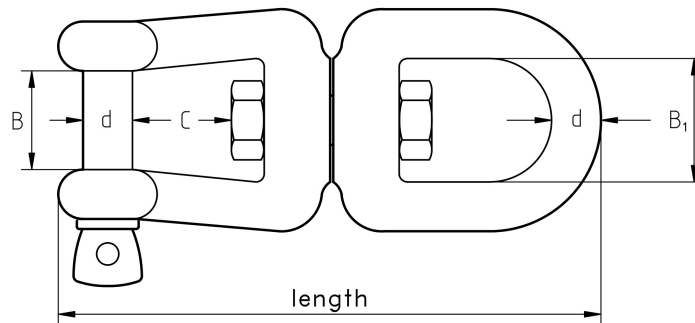

Figure 1: Swivel Shackle with Eye and Fork

Table 1: Dimensions & Tolerances (mm), and Loadings (kg)

d	Length	B	C	B1	Breaking Load (kg)	Working Load (kg)
6	66	12	11	15	935	235
8	92	16	16	20	1660	415
10	118	20	22	24	2590	648
13	152	26	28	32	3730	930
16	188	32	37	39	6630	1660
19	229	38	45	41	-	-