



[Browse Product Range >](#)

Westfield Fasteners Product Specification:

ASME B18.6.3 - UNC Slotted Pan Head Machine Screws

This product guide contains the specification for UNC thread Slotted Pan Head Machine Screws, a series of standard parts available from Westfield Fasteners. The basis of this specification is the ASME standard ASME B18.6.3.

Product Description

A pan head machine screw with a slot drive, designed to be tightened with a flat screwdriver. Often used in consumer electronics and other small machinery where high torque fasteners are not needed.

Scope of the ASME Standard

Unlike ISO standards, each ASME standard generally covers a range or family of product types. ASME B18.6.3 covers many machine screw types, including these UNC slotted pan machine screws and describes the form, dimensions and tolerances, starting from the diameter of gauge size 0000, up to and including 3/4 inch.

The slot drive can have parallel or slightly tapered sides.

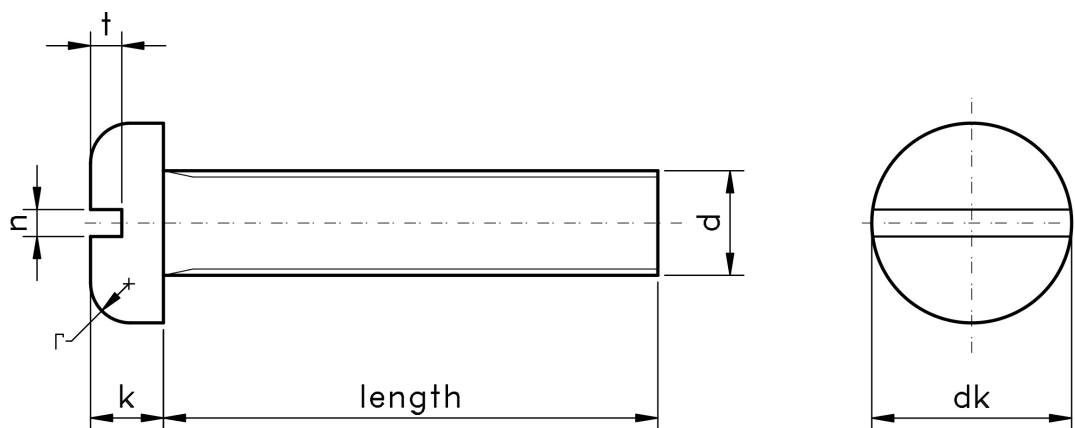

Figure 1: UNC Slotted Pan Head Machine Screw

Table 1: Dimensions & Tolerances of UNC Slotted Pan Machine Screws according to ASME B18.6.3 (inches)

Nominal Size or Basic Screw Diameter, d		Head Diameter, dk		Head Height, k		Head Edge Radius, r	Slot Width, n		Slot Depth, t	
		max	min	max	min	max	max	min	max	min
0000	0.0210	0.042	0.036	0.016	0.010	0.007	0.008	0.004	0.008	0.004
000	0.0340	0.066	0.060	0.023	0.017	0.010	0.012	0.008	0.012	0.008
00	0.0470	0.090	0.082	0.032	0.025	0.015	0.017	0.010	0.016	0.010
0	0.0600	0.116	0.104	0.039	0.031	0.020	0.023	0.016	0.022	0.014
1	0.0730	0.142	0.130	0.046	0.038	0.025	0.026	0.019	0.027	0.018
2	0.0860	0.167	0.155	0.053	0.045	0.035	0.031	0.023	0.031	0.022
3	0.0990	0.193	0.180	0.060	0.051	0.037	0.035	0.027	0.036	0.026
4	0.1120	0.219	0.205	0.068	0.058	0.042	0.039	0.031	0.040	0.030
5	0.1250	0.245	0.231	0.075	0.065	0.044	0.043	0.035	0.045	0.034
6	0.1380	0.270	0.256	0.082	0.072	0.046	0.048	0.039	0.050	0.037
7	0.1510	0.296	0.281	0.089	0.079	0.049	0.048	0.039	0.054	0.041
8	0.1640	0.322	0.306	0.096	0.085	0.052	0.054	0.045	0.058	0.045
10	0.1900	0.373	0.357	0.110	0.099	0.061	0.060	0.050	0.068	0.053
12	0.2160	0.425	0.407	0.125	0.112	0.078	0.067	0.056	0.077	0.061
14	0.2420	0.476	0.457	0.139	0.126	0.087	0.075	0.064	0.085	0.068
1/4	0.2500	0.492	0.473	0.144	0.130	0.087	0.075	0.064	0.087	0.070
16	0.2680	0.528	0.508	0.153	0.139	0.094	0.075	0.064	0.093	0.074
18	0.2940	0.579	0.558	0.168	0.153	0.099	0.084	0.072	0.100	0.080
5/16	0.3125	0.615	0.594	0.178	0.162	0.099	0.084	0.072	0.106	0.085
20	0.3200	0.631	0.608	0.182	0.166	0.121	0.084	0.072	0.108	0.087
24	0.3720	0.734	0.709	0.211	0.193	0.143	0.094	0.081	0.123	0.100
3/8	0.3750	0.740	0.716	0.212	0.195	0.143	0.094	0.081	0.124	0.100
7/16	0.4375	0.863	0.837	0.247	0.228	0.153	0.094	0.081	0.142	0.116
1/2	0.5000	0.987	0.958	0.281	0.260	0.175	0.106	0.091	0.161	0.131
9/16	0.5625	1.041	1.000	0.315	0.293	0.197	0.118	0.102	0.179	0.146
5/8	0.6250	1.172	1.125	0.350	0.325	0.219	0.133	0.116	0.197	0.162
3/4	0.7500	1.435	1.375	0.419	0.390	0.263	0.149	0.131	0.234	0.192

For further details, please refer to the ASME standard document for this item.