



[Browse Product Range >](#)

## Westfield Fasteners Product Specification:

# DIN 6923 - Hex Flange Nut, Unserrated, with Fine Pitch Thread

This product guide contains the specification for metric unserrated hex flange nuts with a fine pitch thread. These items are a standard stock item available from Westfield Fasteners. The basis of this specification is the DIN standard DIN 6923.

## Product Description

Fine pitch threaded plain hexagon flange nut to DIN standard 6923. The significantly more unusual fine pitch variant of the standard metric coarse pitch plain hex flange, used where more thread engagement is desired. For use in conjunction with a matching fine thread pitch bolts, screws or studs. Typically fitted with a spanner or ratchet with socket.

## Scope of the DIN Standard

DIN 6923 specifies hexagon nuts with a flange for both coarse and fine pitch thread variants. Nominal diameters from M8 to M20 are covered for fine pitch variants in this standard. Both serrated and unserrated versions of nuts to this standard are available on the market. This is the case for fine pitch types as well as the more usual coarse pitch.

Figure 1 and table 1 below outline the form, dimensions and tolerances for these nuts.

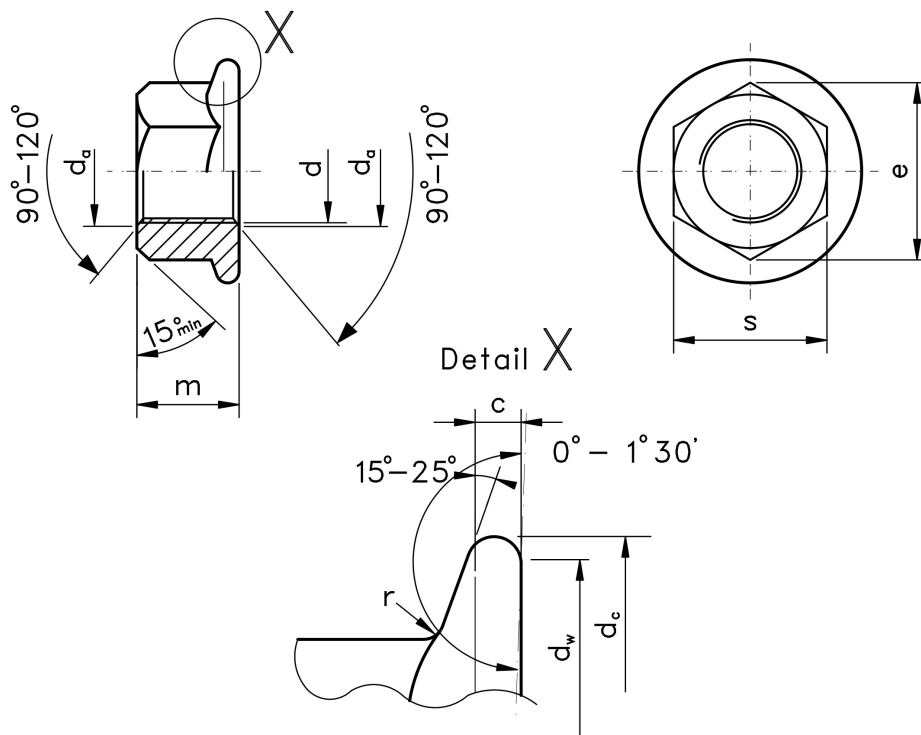

Figure 1: Plain Hex Flange Nut with Fine Pitch Thread

**Table 1: Dimensions & Tolerances according to DIN 6923 (mm)**

Thread, d		M8	M10	M12	M14	M16	M20
Pitch, p		1	1.25	1.5	1.5	1.5	1.5
		-	1.00	1.25	-	-	-
Flange Thickness, c	min	1.2	1.5	1.8	2.1	2.4	3
Inner Bearing Surface Diameter, d <sub>a</sub>	min	8	10	12	14	16	20
	max	8.75	10.8	13	15.1	17.3	21.6
Flange Diameter, d <sub>c</sub>	max	17.9	21.8	26	29.9	34.5	42.8
Outer Bearing Surface Diameter, d <sub>w</sub>	min	15.8	19.6	23.8	27.6	31.9	39.9
Hex Corner to Corner, e	min	14.38	16.64	20.03	23.36	26.75	32.95
Nut Height, m	max	8	10	12	14	16	20
	min	7.6	9.6	11.6	13.3	15.3	18.9
Spanner Size, s	nom=max	13	15	18	21	24	30
	min	12.73	14.73	17.73	20.67	23.67	29.67
Radius, r	max	0.48	0.6	0.72	0.88	0.96	1.2

For further details, please refer to the ISO/DIN standard document for this item.

E&OE