



[Browse Product Range >](#)

Westfield Fasteners Product Specification:

Blind Rivet with Large Dome Head

This product guide contains the specification for blind rivets with a large flange head. This is a range of stock items available from Westfield Fasteners.

Product Description

Standard large flange head open blind rivets are a widely used type of rivet. The wide diameter of the head is larger than that of the standard sized domed head rivet, so increases the bearing area. The large flange head open blind rivets are designed to be used in situations with low load-bearing requirements, such as thin or delicate materials. The large head will offer support at the fixing point and is also good for covering over-sized holes.

Product Information

The overall design of the rivet is based on DIN 7337, but features a non-standard head shape. Aluminium bodied rivets include a zinc plated steel mandrel. Blind rivets are designed to be fitted with a rivet plier or rivet lever type tool.

The data in the table below is provided to assist with installation of these blind rivets. Table 1 defines the overall dimensions and tolerances of this fastener type, and includes shear and tensile strengths, and offers a nominal size for the holes to be used.

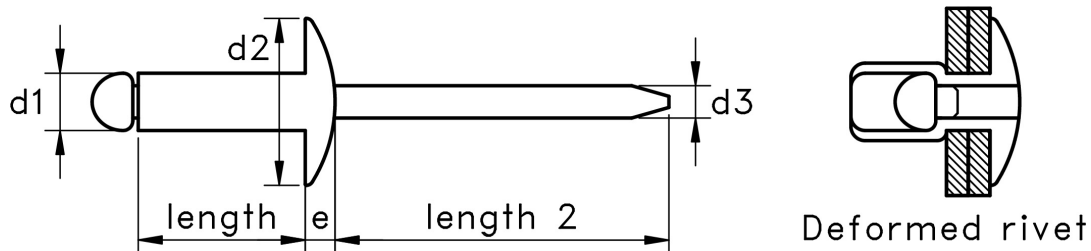

Figure 1: Large Flange Head Open Blind Rivet

Nominal Diameter (d1)	Length	Grip Range	Hole Size	Flange Diameter (d2)	Flange Thickness (e)	Nom. Mandrel Diameter (d3)	Length 2	Shear Strength, Newtons	Tensile Strength, Newtons
3.2	6.0	1.0 - 3.5	3.3	9.5	2.0	1.70	26.0	740	980
	8.0	3.5 - 5.0							
	10.0	5.0 - 7.0							
	12.0	7.0 - 9.0							
	14.0	9.0 - 11.0							
4.0	6.0	0.5 - 2.0	4.1	12.0	2.5	2.10	27.0	1180	1600
	8.0	2.0 - 4.0							
	10.0	4.0 - 6.0							
	12.0	6.0 - 8.0							
	14.0	8.0 - 10.0							
	16.0	10.0 - 12.0							
	18.0	12.0 - 14.0							
	20.0	14.0 - 15.5							
4.8	10.0	3.5 - 5.5	4.9	14.0	2.5	2.70	28.0	1540	2230
	12.0	5.5 - 7.5							
	14.0	7.5 - 9.5							
	16.0	9.0 - 11.0							
	18.0	11.0 - 13.0							
	20.0	13.0 - 15.0							
	22.0	15.0 - 17.0							