



[Browse Product Range >](#)

Westfield Fasteners Product Specification:

Dome Head Peel Type Blind Rivets

This product guide contains the specification for dome head peel type blind rivets. These items form part of the Westfield Fasteners range of blind or pop rivet products.

Product Description

Dome head peel type blind rivets are designed to be used with soft or low resistance materials and are ideal for connecting soft materials to harder materials. Use with plastics, rubber, laminates, wood, GRP, plasterboard and sheet metals. As the rivet is compressed to secure the fixing, the body of the rivet splits into 4 and curls down to grip into the surface, giving a wide bearing area.

Blind rivets can be also known as breakstem rivets.

Product Information

Aluminium bodied rivets include a zinc plated steel mandrel. Blind rivets are designed to be fitted with a rivet plier or rivet lever type tool.

The data in the table below is provided to assist with installation of these blind rivets. Table 1 defines the overall dimensions and tolerances of this fastener type, and includes shear and tensile strengths, and offers a nominal size for the holes to be used.

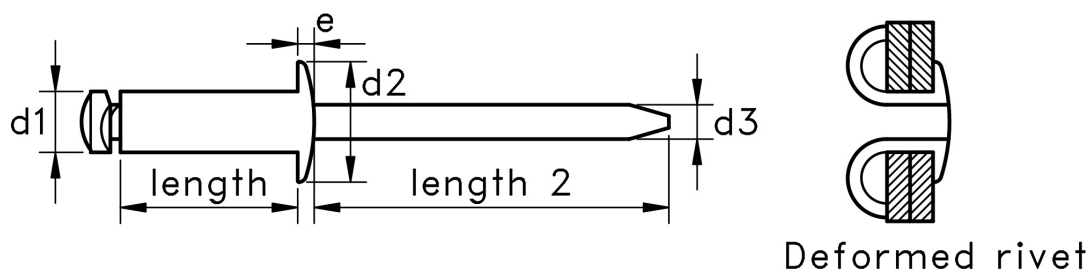

Figure 1: Dome Head Peel Type Blind Rivet

Table 1: Peel Type Blind Rivet Dimensions & Tolerances (mm)

Nominal Diameter (d1)	Length	Grip Range	Hole Size	Flange Diameter (d2)	Flange Thickness (e)	Nom. Mandrel Diameter (d3)	Length 2	Shear Strength, Newtons	Tensile Strength, Newtons
3.2	8.0	0.5 - 1.0	3.5 - 3.7	6.0	0.8	1.90	26.0	765	700
	10.0	1.0 - 3.0							
	12.0	3.0 - 5.0							
	16.0	7.0 - 9.0							
4.0	10.0	1.5 - 4.5	4.3 - 4.5	8	1.2	2.30	27.0	1260	1150
	12.0	4.0 - 6.5							
	14.0	5.0 - 8.5							
	16.0	8.0 - 10.5							
	18.0	10.0 - 12.5							
	20.0	12.0 - 14.5							
4.8	10.0	0.5 - 4.0	5.1 - 5.3	9.5	1.3	2.60	28.0	2400	2200
	12.0	2.0 - 6.0							
	14.0	4.0 - 8.0							
	16.0	6.0 - 9.5							
	18.0	8.0 - 11.0							
	20.0	10.0 - 14.0							
	22.0	12.0 - 16.0							
	25.0	16.0 - 19.0							
	30.0	19.0 - 24.0							
	35.0	24.0 - 28.0							