

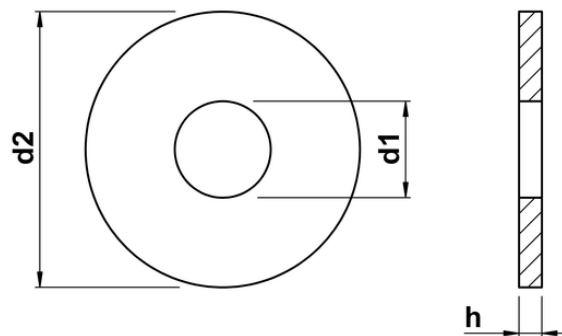

Washers DIN 9021

A large diameter washer where the external diameter is typically three times that of the nominal internal diameter. Also known as Form G, and complies with DIN 9021. Please note that due to manufacturing limitations, all nylon variants of these items are only "similar to" and not "in absolute accordance with" the standard specified.



| d1 | for | d2 | h |
|------|------|-----|-----|
| 2.2 | M2 | 7 | 0.8 |
| 2.7 | M2.5 | 8 | 0.8 |
| 3.2 | M3 | 9 | 0.8 |
| 3.7 | M3.5 | 11 | 0.8 |
| 4.3 | M4 | 12 | 1.0 |
| 5.3 | M5 | 15 | 1.2 |
| 6.4 | M6 | 18 | 1.6 |
| 7.4 | M7 | 22 | 2.0 |
| 8.4 | M8 | 24 | 2.0 |
| 10.5 | M10 | 30 | 2.5 |
| 13.0 | M12 | 37 | 3.0 |
| 15.0 | M14 | 44 | 3.0 |
| 17.0 | M16 | 50 | 3.0 |
| 20.0 | M18 | 56 | 4.0 |
| 22.0 | M20 | 60 | 4.0 |
| 26.0 | M24 | 72 | 5.0 |
| 33.0 | M30 | 92 | 6.0 |
| 39.0 | M36 | 110 | 8.0 |