

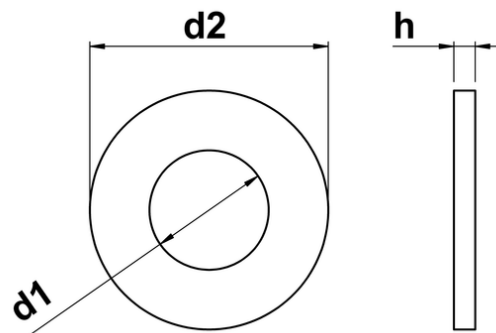

Flat Washers Commercial Series

Imperial Commercial Series washers imported from the USA. Similar thickness to the imperial Table 3 washers, also available on this site, but with a larger outer diameter. Available in 316 (A4) grade stainless steel, so ideal for marine use.



for	d1	d2	h
No. 10	0.208-0.198	0.443-0.433	0.035-0.041
1/4	0.291-0.276	0.635-0.620	0.045-0.055
5/16	0.355-0.340	0.760-0.745	0.045-0.055
3/8	0.416-0.399	0.885-0.870	0.045-0.055
7/16	0.479-0.464	1.135-1.120	0.052-0.072
1/2	0.573-0.558	1.260-1.245	0.057-0.067
5/8	0.703-0.681	1.520-1.495	0.068-0.088
3/4	0.827-0.806	1.770-1.745	0.095-0.115
7/8	0.952-0.930	2.020-1.995	0.095-0.115
1	1.077-1.055	2.020-1.995	0.095-0.115
1 - 1/8	1.202-1.182	2.520-2.495	0.115-0.135
1 - 1/4	1.327-1.305	2.770-2.745	0.115-0.135
1 - 1/2	1.640-1.620	3.270-3.245	0.115-0.135