

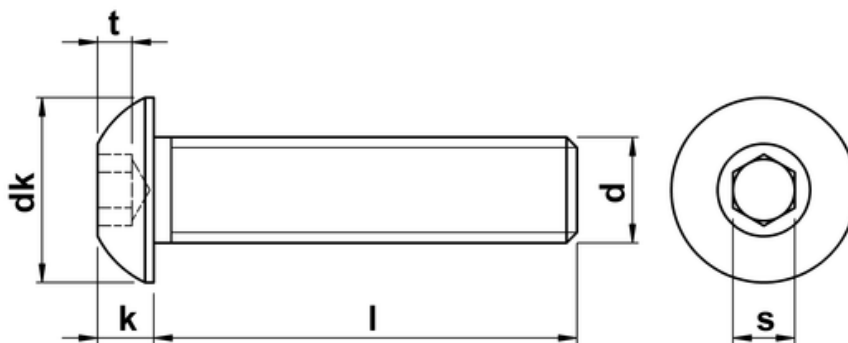

UNF Socket Head Button Screws

A popular and attractive socket head screw, typically used where aesthetics are important, or where a lower profile domed finish is required. The hex drive is generally smaller than other hex driven ranges and thus the ultimate tightening torque is reduced. Manufactured to ASME/ANSI B18.3, and always fully threaded.



d	tpi	dk	k	t	s
0-80	80	0.114	0.032	0.020	0.035
1-72	72	0.139	0.039	0.028	0.050
2-64	64	0.164	0.046	0.028	0.050
3-56	56	0.188	0.052	0.035	1/16
4-48	48	0.213	0.059	0.035	1/16
5-44	44	0.238	0.066	0.044	5/64
6-40	40	0.262	0.073	0.044	5/64
8-36	36	0.312	0.087	0.052	3/32
10-32	32	0.361	0.101	0.070	1/8
1/4	28	0.437	0.132	0.087	5/32
5/16	24	0.547	0.166	0.105	3/16
3/8	24	0.656	0.199	0.122	7/32
7/16	14	-	-	-	-
1/2	20	0.875	0.265	0.175	5/16
5/8	18	1.00	0.331	0.210	3/8