

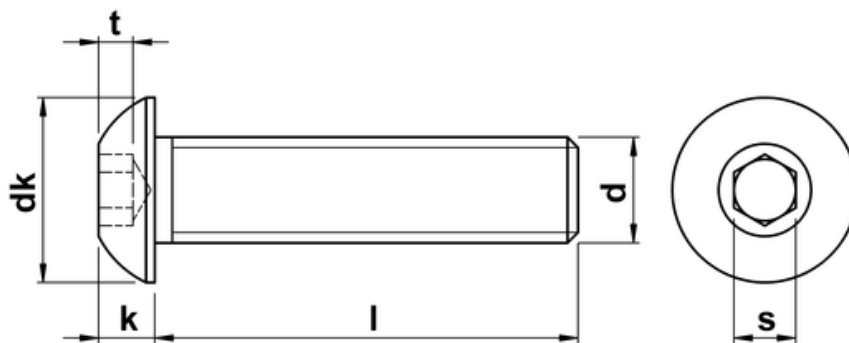

UNC Socket Head Button Screws ASME B18.3-2012

A popular and attractive socket head screw, typically used where aesthetics are important, or where a lower profile domed finish is required. The hex drive is generally smaller than other hex driven ranges and thus the ultimate tightening torque is reduced. Manufactured to ASME/ANSI B18.3, and always fully threaded.



d	tpi	dk	k	t	s
1-64	64	0.139	0.032	0.028	0.050
2-56	56	0.164	0.039	0.028	0.050
3-48	48	0.188	0.046	0.035	1/16
4-40	40	0.213	0.052	0.035	1/16
5-40	40	0.238	0.059	0.044	5/64
6-32	32	0.262	0.066	0.044	5/64
8-32	32	0.312	0.073	0.052	3/32
10-24	24	0.361	0.087	0.070	1/8
1/4	20	0.437	0.101	0.087	5/32
5/16	18	0.547	0.132	0.105	3/16
3/8	16	0.656	0.166	0.122	7/32
7/16	14	-	-	-	-
1/2	13	0.875	0.265	0.175	5/16
5/8	11	1.00	0.331	0.210	3/8