

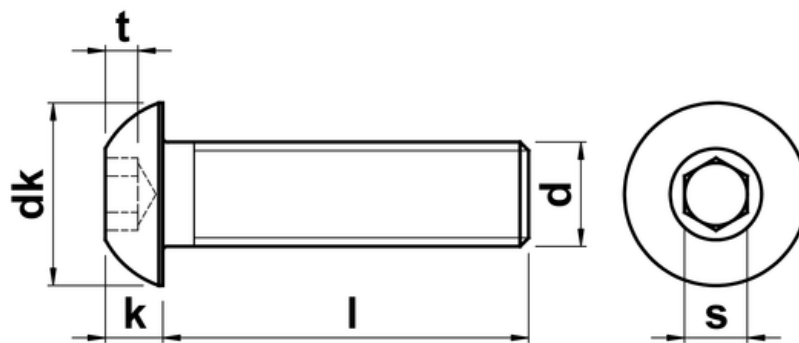

Socket Head Button Screws ISO 7380 part 1

A popular and attractive socket head screw, typically used where aesthetics are important, or where a lower profile domed finish is required. The hex drive is generally smaller than other hex driven ranges and thus the ultimate tightening torque is reduced. Manufactured to ISO 7380, and almost always fully threaded.



d	thread pitch	dk	k max.	s	t
M2.5	0.45	4.5	1.5	1.5	-
M3	0.50	5.7	1.65	2	1.04
M4	0.70	7.6	2.20	2.5	1.30
M5	0.80	9.5	2.75	3	1.56
M6	1.00	10.5	3.30	4	2.08
M8	1.25	14.0	4.40	5	2.6
M10	1.50	17.5	5.50	6	3.12
M12	1.75	21.0	6.60	8	4.16
M16	2.00	28.0	8.80	10	5.20