

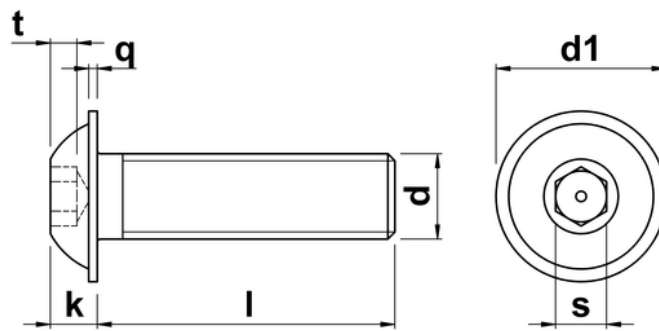

Socket Head Button Screws With Flange ISO 7380 part 2

A popular and attractive socket head screw with an integrated flange offering a wider head for bolting softer materials. Typically used where aesthetics are important, or where a lower profile domed finish is required. The hex drive is generally smaller than other hex driven ranges and thus the ultimate tightening torque is reduced. Manufactured to ISO 7380, the same standard as the non flanged variant, and always fully threaded.



d	thread pitch	d1 max.	k max.	q	t min.	s
M3	0.50	7.0	1.7	0.7	1.05	2
M4	0.70	9.4	2.2	0.8	1.35	2.5
M5	0.80	11.6	2.8	1.0	1.80	3
M6	1.00	13.6	3.3	1.1	2.10	4
M8	1.25	17.8	4.4	1.5	2.80	5
M10	1.50	22	5.5	1.7	3.40	6
M12	1.75	25	7.0	2.4	4.20	8