

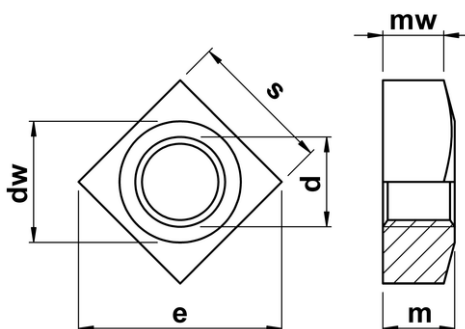

Square Nuts

Compared to standard hex nuts, square nuts have a greater surface contact with the part being fastened, and therefore provide greater resistance to loosening. They are also much less likely to become rounded-off after repeated loosening/tightening cycles. Manufactured to DIN 557.



| d | thread pitch | m | mw | s | e max. | dw min. |
|------------|--------------|------|-----|----|--------|---------|
| M5 | 0.80 | 4.0 | 2.5 | 8 | 11.3 | 6.7 |
| M6 | 1.00 | 5.0 | 3.2 | 10 | 14.1 | 8.7 |
| M8 | 1.25 | 6.5 | 4.1 | 13 | 18.4 | 11.5 |
| M10 | 1.50 | 8.0 | 5.2 | 17 | 22.6 | 14.5 |
| M12 | 1.75 | 10.0 | 6.6 | 19 | 25.4 | 16.5 |
| M16 | 2.00 | 13.0 | 8.6 | 24 | 33.9 | 22.0 |