

PLAN

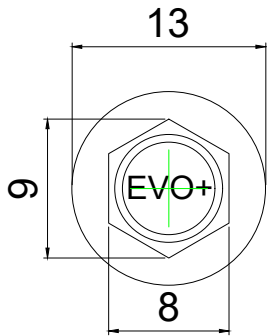

SECTION: TSFHR 8.0-25-1

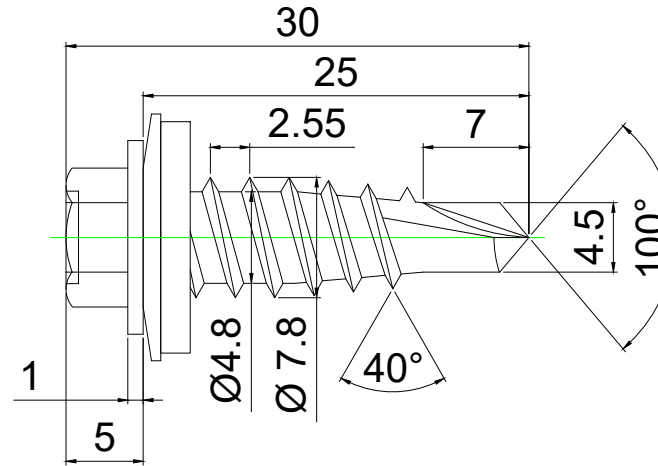

WASHER DETAIL

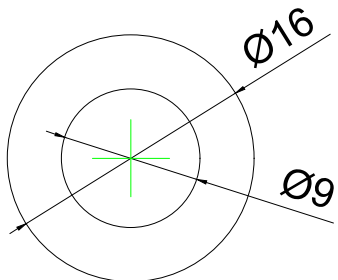
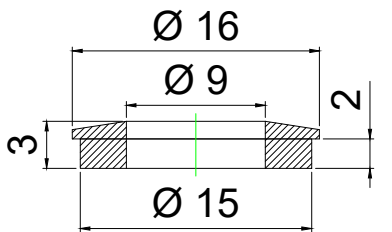

NOTES: Carbon Steel (Evoshield Coating)

Designed for:

Fixing halter brackets, shear studding & components to light gauge steel substrates.

Head Style & Drive type:

$\frac{5}{16}$ " Hexagonal Head male socket.

Washer Type:

16mm \varnothing vulcanised EPDM.

Thread Form:

Coarse thread (Pitch = 2.55mm(approx.)).

Material & Grade:

SAE C1022 Carbon Steel - Drilling point, shank & head.

Coating:

500Hr Evoshield.

Note: Structural sections to be designed by others. Evolution screws specified in accordance with material loads in accordance with material loads provided by project specific engineer. Evolution screws to be installed as per best practice or manufacturers guidelines.			
C	06.09.19	MG	REVISED INTERNAL D1 AND THREAD ANGLE
B	04.09.19	MG	REVISED WASHER DESCRIPTION
A	15.03.18	AW	INITIAL ISSUE
ISS	DATE	DRAWN	MODIFICATION

ALL DIMENSIONS IN MILLIMETRES - DO NOT SCALE			
		DESCRIPTION STITCHING SCREW TSFHR 8.0-25-1 HEX-HEAD (WASHERED)	
QUOTE REF:-	N/A	SIZE-SCALE	1:45
SHEET-	01	ISSUE-	C