

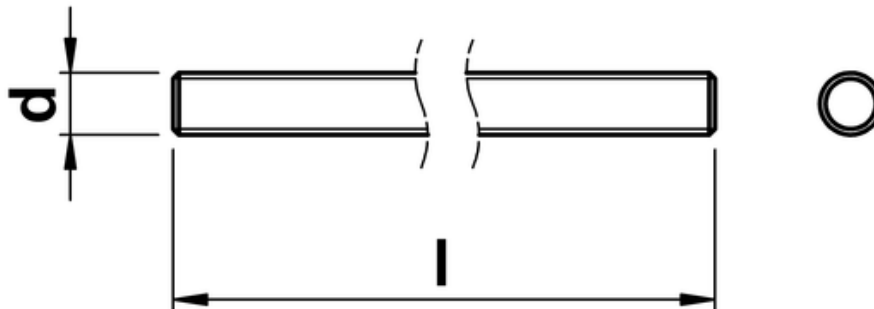

---

## Threaded Rod

Flexible usage threaded bar or threaded rod, also known as Studding. Manufactured to DIN 975. Please note that due to manufacturing limitations, all nylon variants of these items are only "similar to" and not "in absolute accordance with" the standard specified.



<b>d</b>	<b>thread pitch</b>
<b>M2</b>	0.4
<b>M3</b>	0.5
<b>M4</b>	0.7
<b>M5</b>	0.8
<b>M6</b>	1.0
<b>M8</b>	1.25
<b>M10</b>	1.50
<b>M12</b>	1.75
<b>M14</b>	2.00
<b>M16</b>	2.00
<b>M18</b>	2.50
<b>M20</b>	2.50
<b>M22</b>	2.50
<b>M24</b>	3.00