

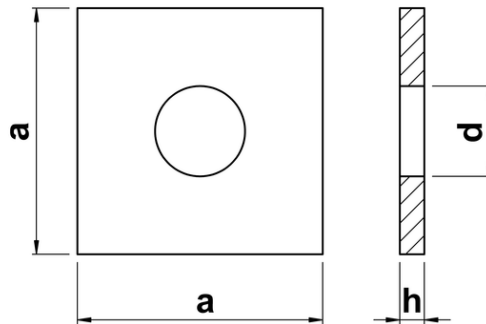

Square Plate Flat Washers DIN 436

Robust flat washer with a large square shape rather than the more usual round. Often used in timber construction and in applications at risk of seismic activity. To DIN 436.



d	for	a	h
11	M10	30	3
13.5	M12	40	4
17.5	M16	50	5
22	M20	60	5
24	M22	70	6
26	M24	80	6